

# KOMBIC 70 DOWNLIGHT

K711544OP940DWW



## KOMBIC 70 1500 IP44 9NW OPAL DA WH/WH

### Description:

KOMBIC 70 round recessed downlight by LAMP. Reflector made of recycled polycarbonate R-PC FR WHITE TM non-brominated flame retardant additive. Flammability grade V0 according to UL94. Inner reflector finished in white and opal optical sheet. Heatsink made of die-cast aluminium with black finish. COB LED, colour temperature 4000K with CRI90. Luminaire with electronic wiring Dali included. Insulation class II. LED life time: 66000 L90 B10. With IP44 degree of protection. Group 0 photobiological safety.

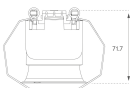
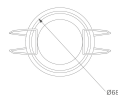

**Finish:** Matte white RAL 9010

**Weight:** 190 g

**Installation:** Recessed

### TECHNICAL SPECIFICATIONS:

<b>Light output:</b>	849 lm	<b>°K :</b>	4000
<b>Plum:</b>	9,5W	<b>CRI :</b>	90
<b>Efficacy:</b>	89,4 lm/w	<b>R9 :</b>	71
<b>Type:</b>	COB	<b>MacAdam:</b>	3
<b>LED Lifetime:</b>	66.000 L90 B10 (Ta=25°C)	<b>Power Supply:</b>	220-240V 50/60Hz
<b>Power:</b>	8,4W	<b>Gear:</b>	Adjustable DALI

*Light output tolerance +/- 10%*

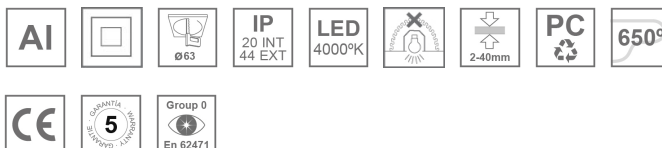

### CUSTOM MADE OPTIONS:



# KOMBIC 70 DOWNLIGHT

K711544OP940DWW

KOMBIC 70 1500 IP44 9NW OPAL DA WH/WH

**PHOTOMETRIC DATA :**

K711544OP940DWW  
 $\eta = 100\%$   
 $I_{max} = 942 \text{ cd/klm}$   
 UTE: 1,00B  
 CIE: 75 94 99 100 100

