

# KOMBIC 70 DOWNLIGHT

K711523WW940NWW



## KOMBIC 70 1500 IP43 9NW WW WH/WH

### Description:

LAMP Round recessed downlight KOMBIC 70 1500 Reflector made of recycled polycarbonate R-PC FR WHITE TM non-brominated flame retardant additive. Flammability grade V0 according to UL94. Wallwasher optic option, suitable for vertical plane lighting or work areas surroundings. Heatsink made of die-cast aluminium with black finish. COB LED, colour temperature 4000K and CRI90. Electronic ON OFF gear included. IP43 rated. Insulation Class II. Photobiological safety group 0. LED life time: 72.000 L80 B10. Available finishes: White and black.

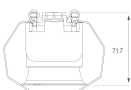
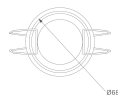

**Finish:** Matte white RAL 9010

**Weight:** 210 g

**Installation:** Recessed

### TECHNICAL SPECIFICATIONS:

<b>Light output:</b>	772 lm	<b>°K :</b>	4000
<b>Plum:</b>	10W	<b>CRI :</b>	90
<b>Efficacy:</b>	77,2 lm/w	<b>R9 :</b>	68
<b>Type:</b>	COB	<b>MacAdam:</b>	3
<b>LED Lifetime:</b>	72.000 L80 B10 (Ta=25°C)	<b>Power Supply:</b>	220-240V 50/60Hz
<b>Power:</b>	8,4W	<b>Gear:</b>	Electronic

*Light output tolerance +/- 10%*

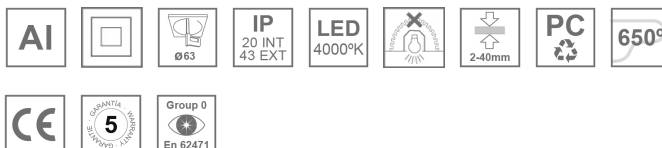

### CUSTOM MADE OPTIONS:



# KOMBIC 70 DOWNLIGHT

K711523WW940NWW

KOMBIC 70 1500 IP43 9NW WW WH/WH

**PHOTOMETRIC DATA :**

K711523WW940NWW  
 $\eta = 100\%$   
 $I_{max} = 1245 \text{ cd/klm}$   
 UTE: 1,00B  
 CIE: 74 93 99 100 100

