

KOMBIC 70 DOWNLIGHT

K711523RW840DWW



KOMBIC 70 1500 IP23 NW RF WFL DA WH/WH

Description:

KOMBIC 70 round recessed downlight by LAMP. Reflector made of recycled polycarbonate R-PC FR WHITE TM non-brominated flame retardant additive. Flammability grade V0 according to UL94. Inner reflector finished in white. Heatsink made of die-cast aluminium with black finish. COB LED, colour temperature 4000K with CRI80. Luminaire with DALI wiring included. Insulation class II. LED life time: 66000 L90 B10. With IP23 degree of protection. Group 0 photobiological safety. Reflector Wide Flood to achieve a controlled light distribution and low glare level.

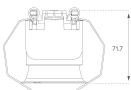
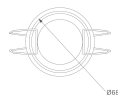

Finish: Matte white RAL 9010

Weight: 190 g

Installation: Recessed

TECHNICAL SPECIFICATIONS:

Light output:	1.158 lm	°K :	4000
Plum:	9,5W	CRI :	80
Efficacy:	121,9 lm/w	MacAdam:	3
Type:	COB	Power Supply:	220-240V 50/60Hz
LED Lifetime:	66.000 L90 B10 (Ta=25°C)	Gear:	Adjustable DALI
Power:	8,4W		

Light output tolerance +/- 10%

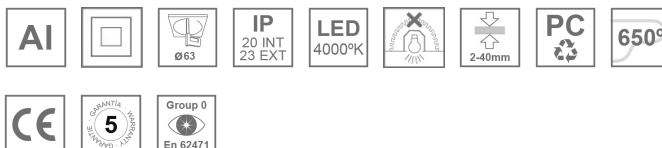

CUSTOM MADE OPTIONS:



KOMBIC 70 DOWNLIGHT

K711523RW840DWW

KOMBIC 70 1500 IP23 NW RF WFL DA WH/WH

PHOTOMETRIC DATA :

K711523RW840DWW
 $\eta = 100\%$
 $I_{max} = 1354 \text{ cd/klm}$
UTE: 1,00A
CIE: 87 96 100 100 100

